

### U35 Points

PART ID	DESCRIPTION	A	B	C	D	WEIGHT
		LENGTH	BIT	BIT	WIDTH AT	
		mm / in	WIDTH	THICKNESS	EARS	kg / lb
			mm / in	mm / in	mm / in	
U35A	Abrasion	279 / 10.98	69 / 2.72	15 / 0.59	119 / 4.67	12.0 / 26.5
U35AHB	Abrasion**	279 / 10.98	69 / 2.72	15 / 0.59	119 / 4.67	12.0 / 26.5
U35AP	Abrasion Penetration	298 / 11.73	48 / 1.89	8 / 0.31	119 / 4.67	10.1 / 22.2
U35APHB	Abrasion Penetration**	298 / 11.73	48 / 1.89	8 / 0.31	119 / 4.67	10.1 / 22.2
U35C	Chisel	291 / 11.46	40 / 1.58	13 / 0.53	119 / 4.67	7.0 / 15.5
U35CHB	Chisel**	291 / 11.46	40 / 1.58	13 / 0.53	119 / 4.67	7.0 / 15.5
U35F	Flare	287 / 11.28	178 / 7.00	16 / 0.63	119 / 4.67	9.3 / 20.4
U35FHB	Flare**	287 / 11.28	178 / 7.00	16 / 0.63	119 / 4.67	9.3 / 20.4
U35H	Heavy	289 / 11.40	41 / 1.60	18 / 0.70	119 / 4.67	8.4 / 18.6
U35P	Pick	298 / 11.71	16 / 0.62	10 / 0.40	119 / 4.67	5.7 / 12.5
U35S	Standard	265 / 10.41	102 / 4.03	11 / 0.43	119 / 4.67	7.0 / 15.3
U35SHB	Standard**	265 / 10.41	102 / 4.03	11 / 0.43	119 / 4.67	7.0 / 15.3
U35T	Twin Pick	298 / 11.72	143 / 5.62	8 / 0.30	119 / 4.67	7.0 / 15.5
U35K	Clamshell	402 / 15.81	80 / 3.17	9 / 0.37	119 / 4.67	9.5 / 20.9
U35KHB	Clamshell**	402 / 15.81	80 / 3.17	9 / 0.37	119 / 4.67	9.5 / 20.9

\*\* Ships with Bolt-in Lock

### Lock Assembly

PART ID	DESCRIPTION	LENGTH mm/in	WEIGHT PER PART kg/lb
U35L-BOX	ULTRALOK LOCK ASSEMBLY-10EA;NONE	27.82 / 1.10	0.07 / 0.16
U35LHB-BOX	ULTRALOK BOLT-IN HS LOCK-10EA;NONE	27.82 / 1.10	0.12 / 0.26

**Note:** Available by the box, 10 locks per box.

#### Standard

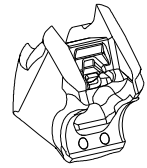

#### LHB



### Pry Tools / Removal Tools

PART ID	DESCRIPTION	WEIGHT kg/lb
CPB8G	PRY BAR WITH HANDLE-SMALL;	0.14 / 0.30
84005	FINES PICK TOOL-SMALL;	0.05 / 0.10

#### CPB8G

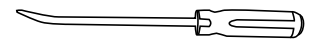

#### 84005



### Weld-on Nose

PART ID	DESCRIPTION	A WIDTH mm/in	B HEIGHT mm/in	C J-GROOVE mm/in	WEIGHT kg/lb
WN-U35	Weld-on Nose	115 / 4.53	110 / 4.31	27 / 1.05	5.6 / 12.3

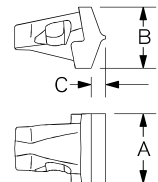

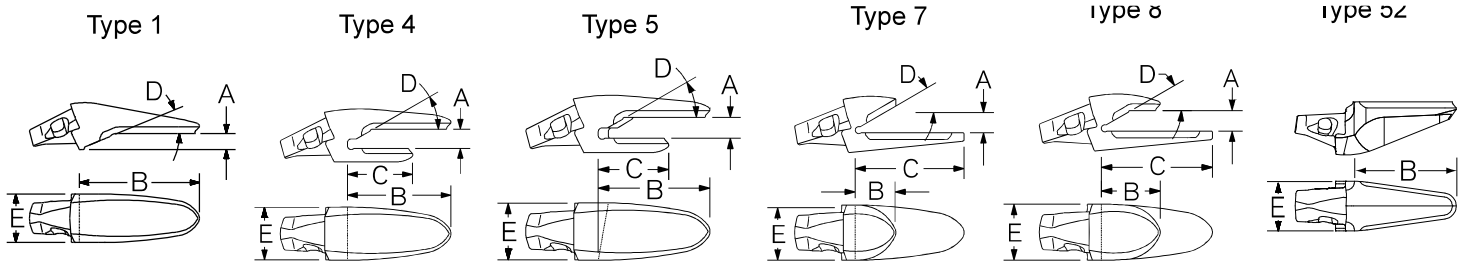

### U35 Adapters

PART ID	TYPE	DESCRIPTION	A LIP THICKNESS mm / in	B TOP LEG mm / in	C BOTTOM LEG mm / in	D RAMP ANGLE deg	E ADAPTER WIDTH mm / in	NOSE ANGLE deg	WEIGHT kg / lb	MACHINE TYPE
<b>Excavator</b>										
5855-U35	8	1-1/2 Bottom Leg	40 / 1.50	127 / 5.00	235 / 9.25	30	115 / 4.53	10	11.9 / 26.3	EXC
3810B-U35	8	1-1/2 Bottom Leg	45 / 1.75	127 / 5.00	235 / 9.25	30	115 / 4.53	10	12.2 / 27.0	EXC
3872A-U35	7	Bottom Leg	40 / 1.50	65 / 2.55	216 / 8.50	30	115 / 4.53	10	10.7 / 23.5	EXC
<b>Wheel Loader</b>										
8833-U35	4	1-1/2 Top Leg	40 / 1.50	217 / 8.52	108 / 4.27	22.5-25	115 / 4.53	15	12.6 / 27.8	FEL
8883-U35	4	1-1/2 Top Leg	52 / 2.05	217 / 8.52	108 / 4.27	22.5-25	115 / 4.53	15	12.8 / 28.1	FEL
4824R-U35	5	1-1/2 Top Leg	45 / 1.75	203 / 7.99	97 / 3.81	22.5-25	115 / 4.53	15	11.4 / 25.2	FEL
4824L-U35	5	1-1/2 Top Leg	45 / 1.75	203 / 7.99	97 / 3.81	22.5-25	115 / 4.53	15	11.4 / 25.2	FEL
8831-U35	1	Flushmount	40-45 / 1.50-1.75	252 / 9.94	N/A	22.5-25	115 / 4.53	15	12.2 / 26.9	FEL
<b>Miscellaneous</b>										
3898-U35	52	Flushmount	N/A	238 / 9.37	N/A	0	115 / 4.53	15	13.7 / 30.3	Clamshell

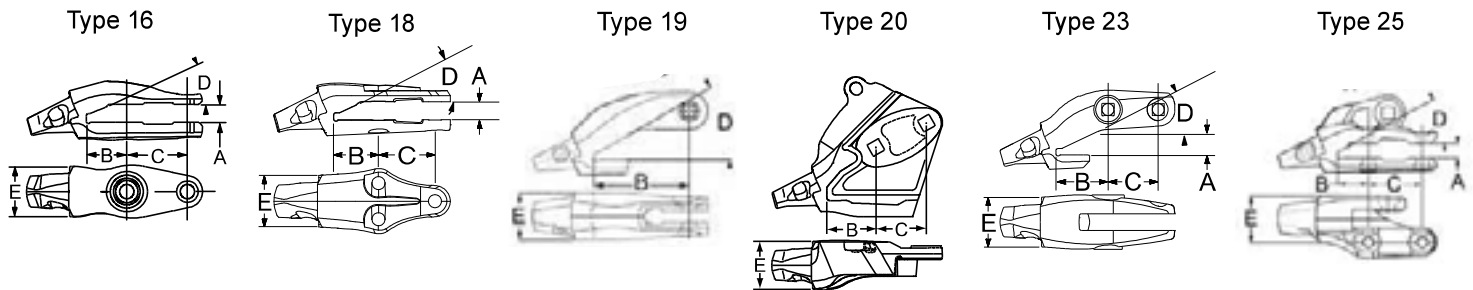

### U35 Bolt-on Adapters

PART ID	TYPE	DESCRIPTION	A LIP THICKNESS mm/in	B 1st BOLT HOLE mm/in	C 2nd BOLT HOLE mm/in	D RAMP ANGLE deg	E ADAPTER WIDTH mm/in	NOSE ANGLE deg	WEIGHT kg/lb	BOLTS (qty) SIZE (in)	MACHINE MODEL
5722-U35	18	2 Leg 3 Bolt	38 / 1.50	98 / 3.87	125 / 4.92	25	115 / 4.53	15	15.5 / 34.1	(3) 1 X 4-1/2 PB *	KAW 90Z II, III, IV, KAW 95Z II, III, IV
5798-U35	23	2 Leg Corner 2 Bolt	38 / 1.50	124 / 4.89	120 / 4.72	25	115 / 4.53	15	17.6 / 38.9	(1) 1 X 4-3/4 PB * (1) 1 X 4 PB *	KAW 90Z II, III, IV, KAW 95Z II, III, IV
7709L-U35	20	2 Bolt Corner Guard	38 / 1.50	129 / 5.08	105 / 4.13	22.5	118 / 4.66	15	36 / 79	(2) 1-1/4 X 4-1/4 PB **	CAT 966F, 970F, 973, 977
7709R-U35	20	2 Bolt Corner Guard	38 / 1.50	129 / 5.08	105 / 4.13	22.5	118 / 4.66	15	36 / 79	(2) 1-1/4 X 4-1/4 PB **	CAT 966F, 970F, 973, 977
7710-U35	16	2 Leg 2 Bolt	38 / 1.50	100.1 / 3.94	150.1 / 5.91	22.5	130 / 5.12	15	20.6 / 45.4	(2) 1-1/4 X 4-1/2 PB ^^	CAT 966F, 970F, 973, 977
5764-U35	18	2 Leg 3 Bolt	35 / 1.38	72 / 2.83	125 / 4.92	24.5	137 / 5.38	15	16.6 / 36.5	(3) 7/8 X 4 PB ^	KOM WA380-3, WA420-3, WA450-3
5765L-U35	25	3 Leg Corner 3 Bolt	35 / 1.38	72 / 2.83	125 / 4.92	24.5	173 / 6.82	15	18.2 / 40.0	(2) 7/8 X 4 PB ^ (1) 1 X 3 PB +	KOM WA380-3, WA420-3, WA450-3
5765R-U35	25	3 Leg Corner 3 Bolt	35 / 1.38	72 / 2.83	125 / 4.92	24.5	173 / 6.82	15	18.2 / 40.0	(2) 7/8 X 4 PB ^ (1) 1 X 3 PB +	KOM WA380-3, WA420-3, WA450-3
8719-U35	16	2 Leg 2 Bolt	38 / 1.50	110 / 4.33	100 / 3.94	25	116 / 4.58	15	19.5 / 43.1	(2) 1-1/4 X 4-1/2 PB ^^	VOLVO L150C/D/E, L180C/D/E
5773-U35	23	2 Leg Corner 2 Bolt	40 / 1.57	151 / 5.94	81 / 3.19	25	115 / 4.53	15	18.0 / 39.8	(2) 1 X 3-1/2 PB +	VOLVO L150C/D/E, L180C/D/E
8785-U35	16	2 Leg 2 Bolt	38 / 1.50	103 / 4.06	130 / 5.11	30	114 / 4.5	15	20 / 43.1	(2) 1-1/4 X 4-1/2 PB ^^	DEERE 744, 824
8786-U35	19	2 Leg Corner 1 Bolt	38 / 1.50	294 / 11.57	N/A	30	115 / 4.53	15	26.5 / 58.4	(1) 1-1/4 X 4-1/4 PB ^^	DEERE 744, 824

\* Use with 1" standard hex nut

^ Use with 7/8" x 45 degree tapered nut

\*\* Use with 1-1/4" standard hex nut

^^ Use with 1-1/4" x 45 degree tapered nut

+ Use with 1" x 45 degree tapered nut